

Desens[®] Bio-Care

A special dental care gel for stronger teeth, caries prevention, and sensitivity relief

More comfort, Greater strength



Convenient application, superior protection

Safe fluoride concentration (900 ppm): Suitable for both adults and children

Versatile application: Suitable for both clinical and home care

Stronger teeth, better well-being

Patented MBG and fluoride: Rapid remineralization for stronger and better-protected teeth

Proven dental care gel from a trusted manufacturer

Desens[®] Bio-Care

A special dental care gel for daily use by both adults and children,
in clinics and at home:

To strengthen teeth, prevent caries, and relieve sensitivity

Desens[®] Bio-Care is a daily-care dental gel suitable for both professional and home use. Its patented MBG (Mesoporous Bioactive Glass) and fluoride react with saliva to release calcium and phosphate, rapidly forming hydroxyapatite - the main component of teeth and bones. This results in stronger teeth, a reduced risk of caries, and decreased sensitivity. Desens[®] Bio-Care promote oral wellness across all age groups.

Indications

- Relief from sensitivity in exposed cervical areas and hypersensitive teeth
- Reduction of post-treatment sensitivity after scaling or tooth whitening
- Reinforcement of weakened enamel due to white spot lesions or early caries
- Protection for high-risk teeth due to hygiene challenges (orthodontic patients, children, military personnel)

Benefits

- Supports long-term success of clinical treatments
- Professional guidance for targeted care of problem areas
- Effective and long-term dental protection with daily use
- Smooth texture and pleasant peach flavor for enjoyable use

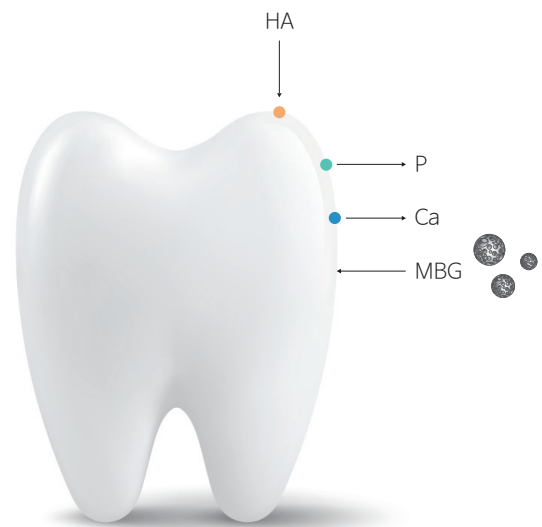

Dentin Fluid Flow Analysis (Real-time)

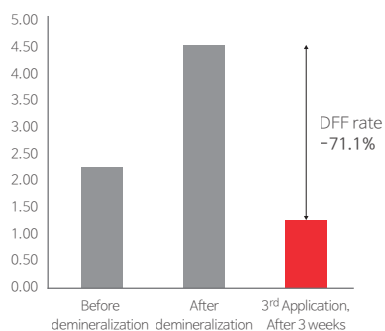

Desens[®] Bio-Care

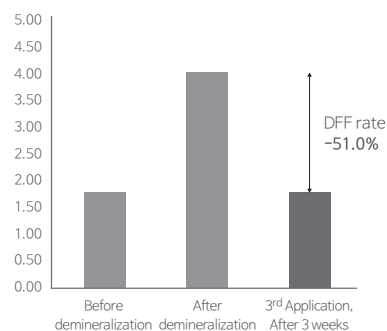

Product C

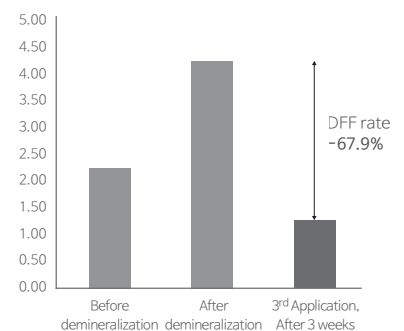

Product T

* Source: Department of Conservative Dentistry, Kyung Hee University Dental Hospital

Dentin Remineralization Effect 1 (5 min/day)

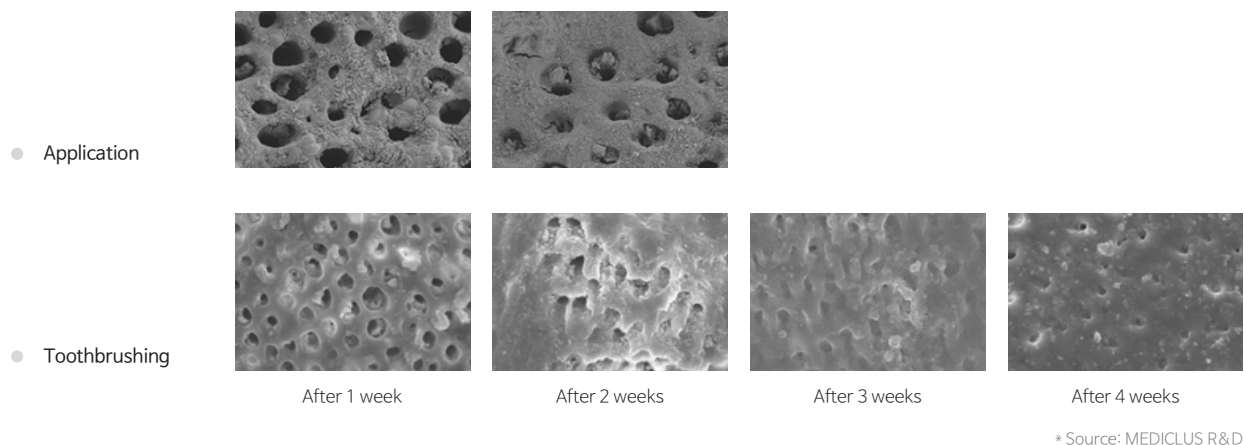

Dentin Remineralization Effect 2 (24 hours)

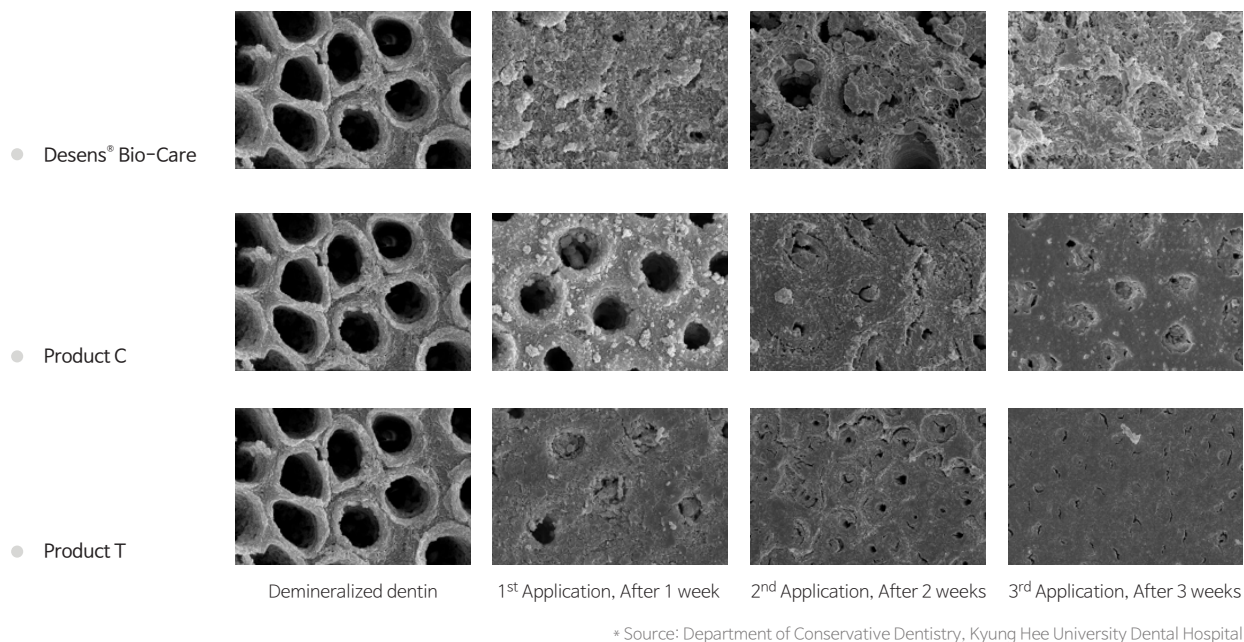

Mineral Content Analysis (Dentin, 24 hours)

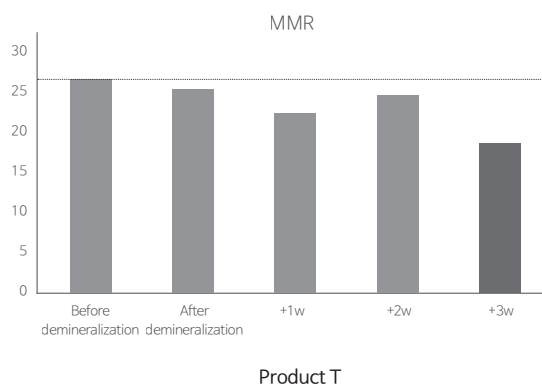
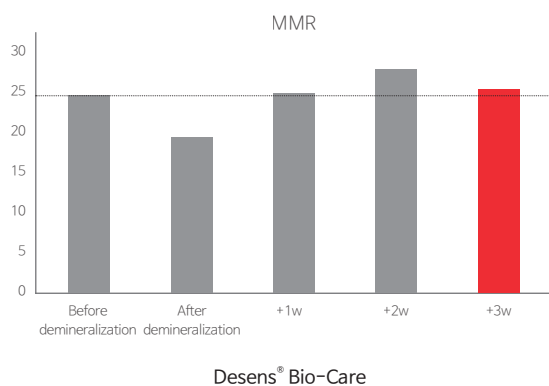

* Source: Department of Conservative Dentistry, Kyung Hee University Dental Hospital

Instructions for Use

- Use in place of toothpaste for brushing
- Use with an interdental brush
- Place in a tray and apply intraorally

Step by Step Process

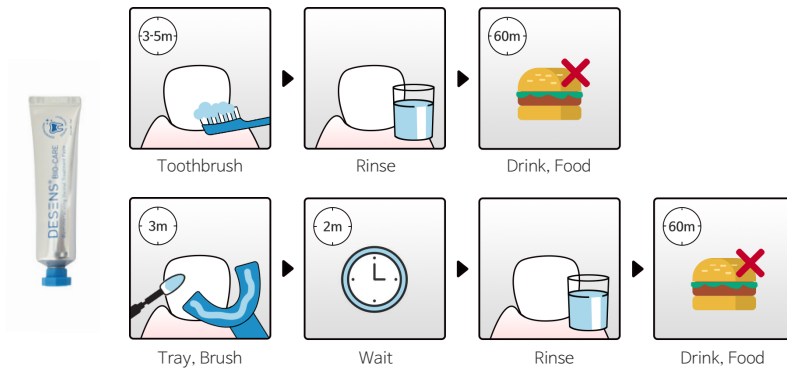

Delivery Forms



Desens® Bio-Care

#401-4 Desens Bio-Care 30mlx 1ea

MEDICLUS

Headquarter | No.1210, 134, Gongdan-ro, Heungdeok-gu, Cheongju-si, Chungcheongbuk-do, 28576, Korea | +82 43 211 2877

Sales Office | No.206 Brown Stone, 464, Cheongpa-ro, Jung-gu, Seoul, 04510, Korea | +82 10 8385 2877

www.mediclus.co.kr | sales@mdclus.com

